

VEHICLE AUDI RS3 8V
YEAR 2015 - 2018

SYSTEM NO
NOTES

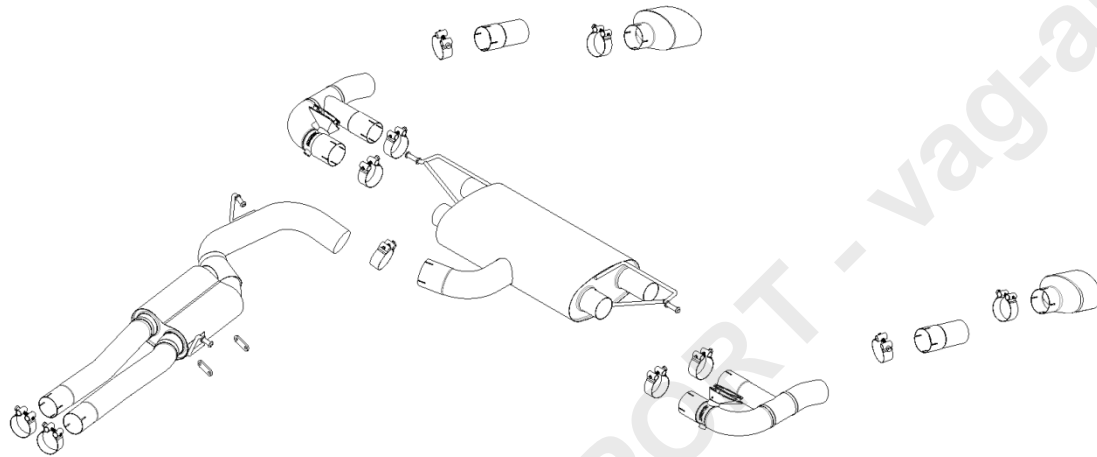

PART NUMBER	DESCRIPTION	QUANTITY	IN PACKAGE
MSAU764REP	FRONT SECTION REP PIPE	1	
CHC68SS	68MM CLAMP	2	
F20050	SPACER	2	
2. MSAU827	REAR SECTION	1	
CHC83SS	83MM CLAMP	1	
3. MSAU820	LH VALVED OUTLET	1	
M5FLGNUT	M5 FLANGE NUT (CHECK THESE ARE ATTACHHD TO VALVE)	3	
F3160	SPRING	1	
CHC66.5SS	66.5MM CLAMP	1	
CHC73SS	73MM CLAMP	1	
USES OE ACTUATOR, MAKE SURE MILLTEK VALVE IS IN CLOSED POSITION WHEN INSTALLING ACTUATOR. ONCE VEHICLE IS SWITCHED ON, SPRING AND VALVE WILL ALIGN AND OPERATE AS STANDARD			

4.	MSAU821	RH VALVED OUTLET	1	
	M5FLGNUT	M5 FLANGE NUT (CHECK THESE ARE ATTACHHD TO VALVE)	3	
	F3160	SPRING	1	
	CHC66.5SS	66.5MM CLAMP	1	
	CHC73SS	73MM CLAMP	1	
<p>USES OE ACTUATOR, MAKE SURE MILLTEK VALVE IS IN CLOSED POSITION WHEN INSTALLING ACTUATOR. ONCE VEHICLE IS SWITCHED ON, SPRING AND VALVE WILL ALIGN AND OPERATE AS STANDARD</p>				

TIP OPTIONS

1.	MSTIP146	LH POLISHED TIP	1	
	CHC73SS	73MM BAND CLAMP	1	
2.	MSTIP147	RH POLISHED TIP	1	
	CHC73SS	73MM BAND CLAMP	1	

