

**VEHICLE** AUDI RS3 8V  
**YEAR** 2015 - 2018

**SYSTEM NO**  
**NOTES**

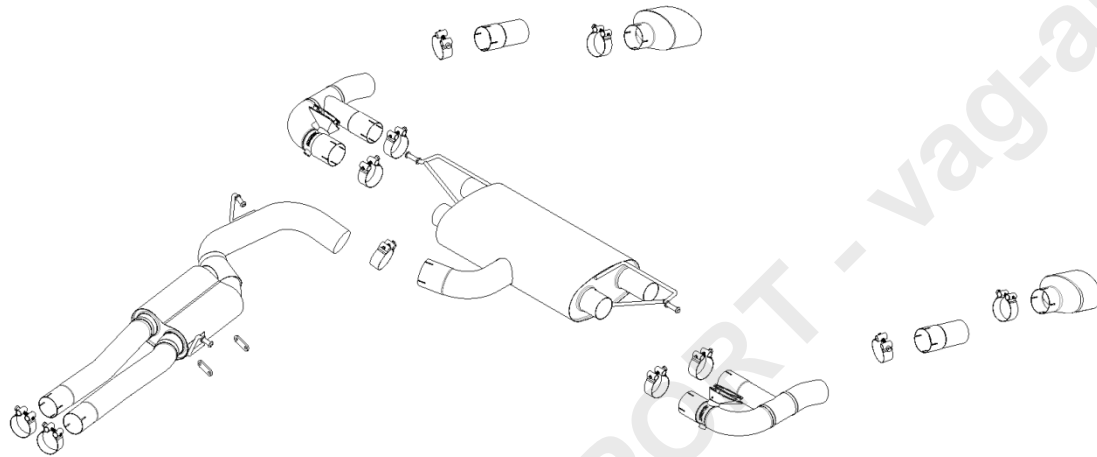

PART NUMBER	DESCRIPTION	QUANTITY	IN PACKAGE
<b>1.</b> MSAU764	FRONT SECTION	1	
CHC68SS	68MM CLAMP	2	
F20050	SPACER	2	
<b>2.</b> MSAU765	REAR SECTION	1	
CHC83SS	83MM CLAMP	1	
<b>3.</b> MSAU820	LH VALVED OUTLET	1	
M5FLGNUT	M5 FLANGE NUT (CHECK THESE ARE ATTACHHD TO VALVE)	3	
F3160	SPRING	1	
CHC66.5SS	66.5MM CLAMP	1	
CHC73SS	73MM CLAMP	1	
USES OE ACTUATOR, MAKE SURE MILLTEK VALVE IS IN CLOSED POSITION WHEN INSTALLING ACTUATOR. ONCE VEHICLE IS SWITCHED ON, SPRING AND VALVE WILL ALIGN AND OPERATE AS STANDARD			

## TIP OPTIONS

3.	MSTIP144	LH BLACK TIP	1	
	CHC73SS	73MM BAND CLAMP	1	
4.	MSTIP145	RH BLACK TIP	1	
	CHC73SS	73MM BAND CLAMP	1	

---

