

Car	Audi RS3 Saloon 8v (GPF and non GPF models)	Part No.	SAU084
Year	2017-2020	Fit Kits	309FK
Notes	Where not supplied use original fittings	Features	Pipe Diameter:- 80mm

Estimated Fitting Time: 1 Hour 30 Minutes

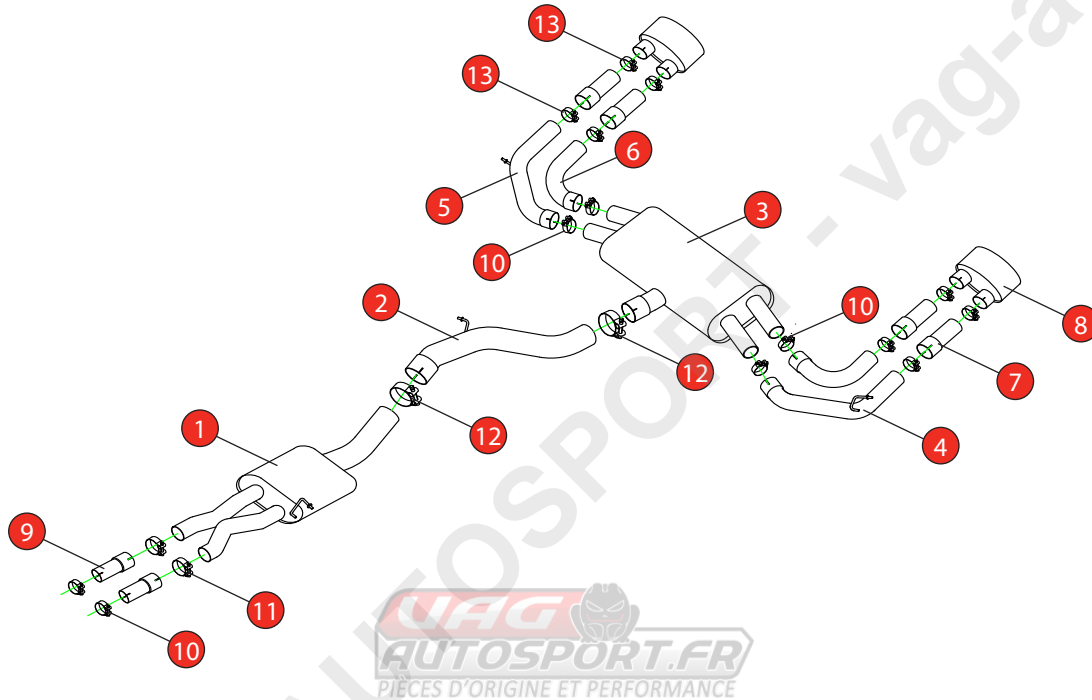

NO.	PART NO.	DESCRIPTION	QTY
1	729AU	Resonated Centre Section	1
2	731AU	Link Pipe	1
3	732AU	Rear Silencer	1
4	736AU	L/H Outer Trim Connecting Pipe	1
5	737AU	R/H Outer Trim Connecting Pipe	1
6	735AU	L/H & R/H Inner Trim Connecting Pipe	2
7	747AU	Trim Extension	4
8	Z043.10187	Polished Evo Trim	2
Fit Kit			
9	AD105	Adaptor	2
10	Z016.10070	65mm H/D Clamp	6
11	Z016.10063	72mm H/D Clamp	2
12	Z016.10069	79-85mm H/D Clamp	2
13	Z016.10064	63-68mm H/D Clamp	8

E-MARK	N/A
DATE	28/02/22
ISSUE	02
AUTHORISED	S Shipley

NOTE: ENSURE SCORPION SYSTEM IS CLEAR OF MOVING PARTS AND ALL ORIGINAL FUNCTIONS WORK CORRECTLY.



STAY CONNECTED TO RED POWER.

Car	Audi RS3 Saloon 8v (GPF and non GPF models)	Part No.	SAU084
Year	2017-2020	Fit Kits	309FK
Notes	Where not supplied use original fittings	Features	Pipe Diameter:- 80mm

Estimated Fitting Time: 1 Hour 30 Minutes



A) Before fitting the Scorpion system, you must rotate the rear mounts by 180° on both sides of the car.



STAY CONNECTED TO RED POWER.