

034Motorsport B8 Audi A4/A5 2.0 TFSI Catch Can Kit Installation



Supplied Parts:

- B8 Audi A4/A5 2.0 TFSI Catch Can with Mounting Bracket
- B8 Audi A4/A5 2.0 TFSI -10 AN Breather Hoses (2)
- B8 Audi A4/A5 2.0 TFSI Valve Cover Breather Adapter
- B8 Audi A4/A5 2.0 TFSI Intake Manifold Plug with Boost Tap
- -10 AN Hose Separator
- M6x25 Bolt (8)
- M6x22 Bolt (1)
- Zip-Tie (1)

Tools Needed:

- Hands (2) (*Opposable thumbs are optional*)
- T30 Torx Driver
- T27 Torx Driver
- Various Allen Drivers
- -10AN Wrench or 1" Hex Wrench

Step 1 – Remove your engine cover by using your hands and/or opposable thumbs to pull up on the plastic cover.

Step 2 – Locate and remove the factory valve cover breather to intake manifold hose. Remove by pinching the plastic clips at the raised/ridged tabs at each end, and sliding the hose firmly out.

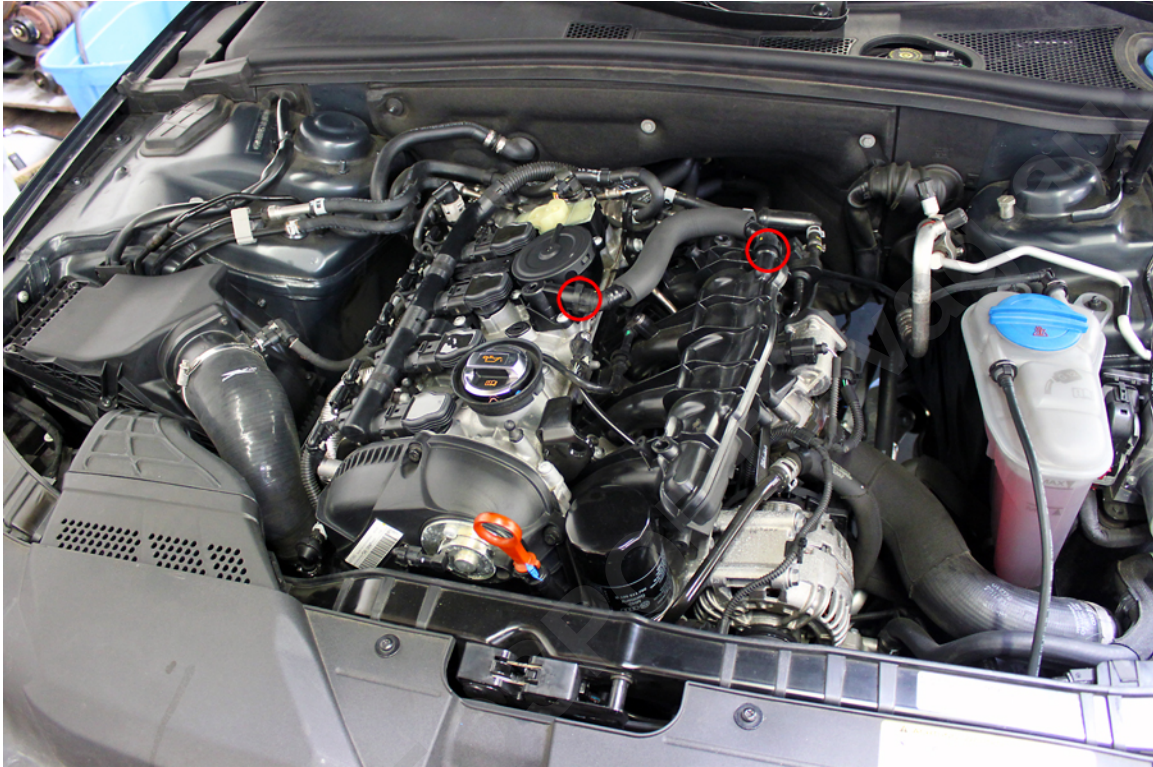

Step 3 – Install the B7 Audi A4 2.0T FSI Intake Manifold Plug to black off the port where the valve cover breather to intake manifold hose was. Rotate the locking tab down to secure the plug against the plastic rib on the intake manifold plenum. *If you intend to use this as a boost tap, unscrew the 1/8" NPT Plug, and replace it with a 1/8" NPT to appropriate barbed brass fitting for use with your boost gauge's vacuum line.*

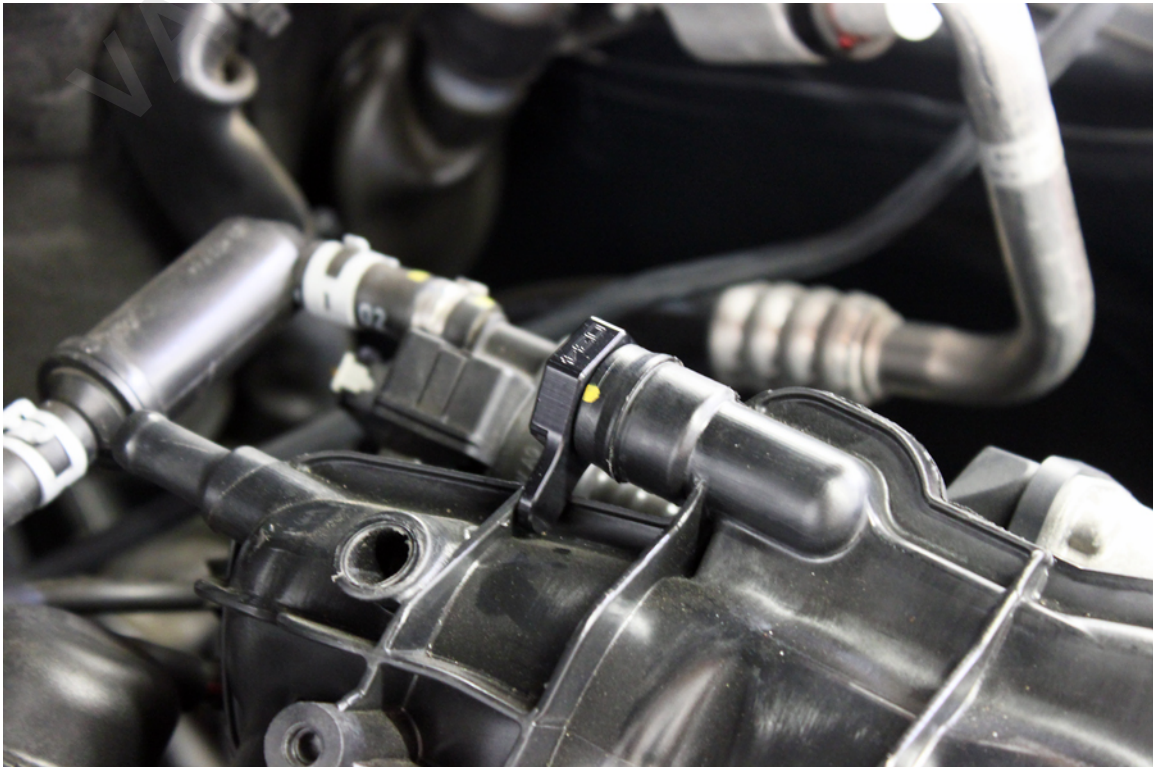

Step 4 – Unbolt the T30 Torx screw securing the coil harness loom, and unplug the coil harness from all 4 coils. You can now access the single T25 Torx screw securing the PCV assembly to compressor inlet tube to the valve cover. Remove the T25 Torx screw and pull to remove the tube from the PCV assembly.

Step 5 – Remove the 9 T25 Torx screws securing the factory PCV assembly to the valve cover, and remove the PCV assembly. *Be careful to avoid dropping any screws into the holes in the valve cover.*



Step 6 – Remove the factory rubber seal from the PCV assembly, and install it into the Valve Cover Breather Adapter.



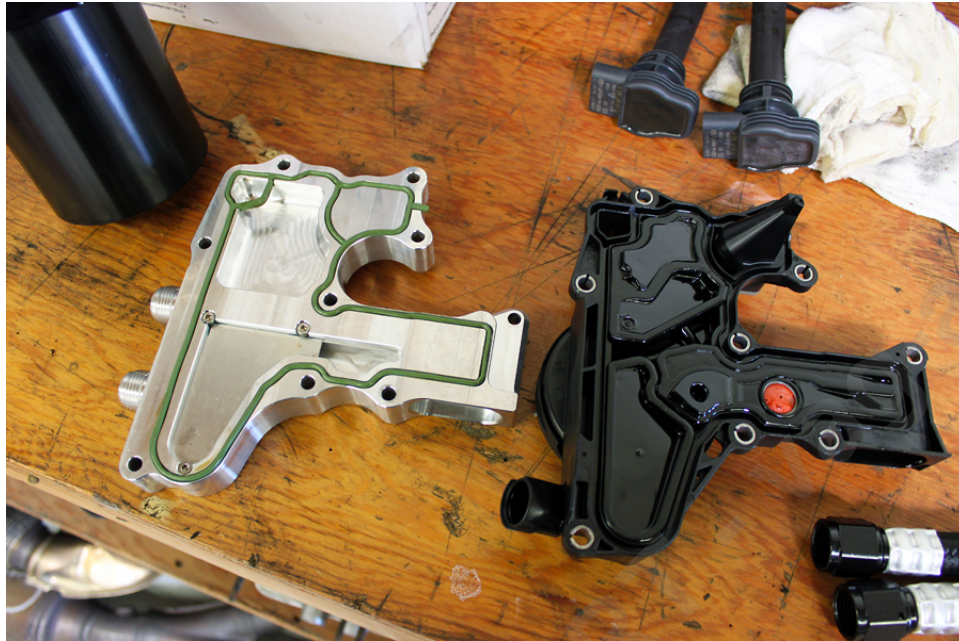

Step 7 – Position the 034Motorsport Valve Cover Breather Adapter such that the holes align with the threaded holes in the valve cover, and push the PCV assembly to compressor inlet tube into it until it seats.



Step 8 – Secure the Valve Cover Breather Adapter to the valve cover using the supplied M6x25 Bolts. The M6X22 Bolt goes into the left-most hole circled above. Secure the PCV assembly to compressor inlet tube to the valve cover using the factory T27 Torx screw.



Step 9 – Plug the coil harness back into all four coils, and secure the loom using the factory T30 Torx screw.

Step 10 – Position the catch can on the core support as shown. There is a locating tab on the bottom portion of the bracket that fits into a hole in the core support. Secure with the top portion of the bracket by tightening the two Allen bolts. If necessary, use supplied Zip-Tie to keep factory hoses from touching catch can.

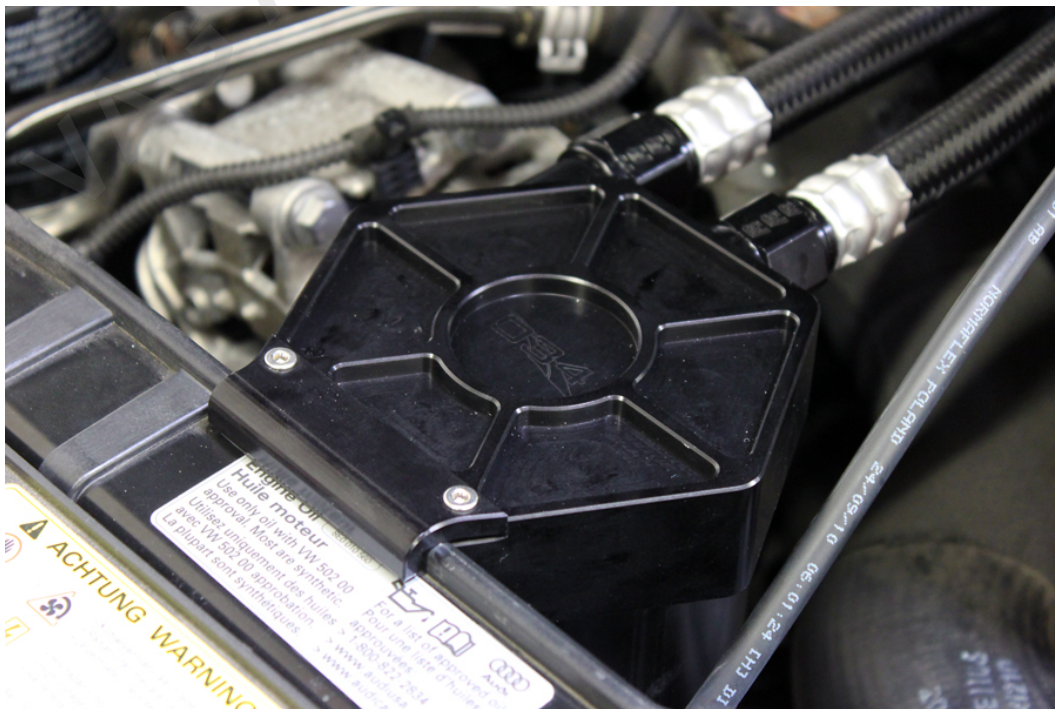

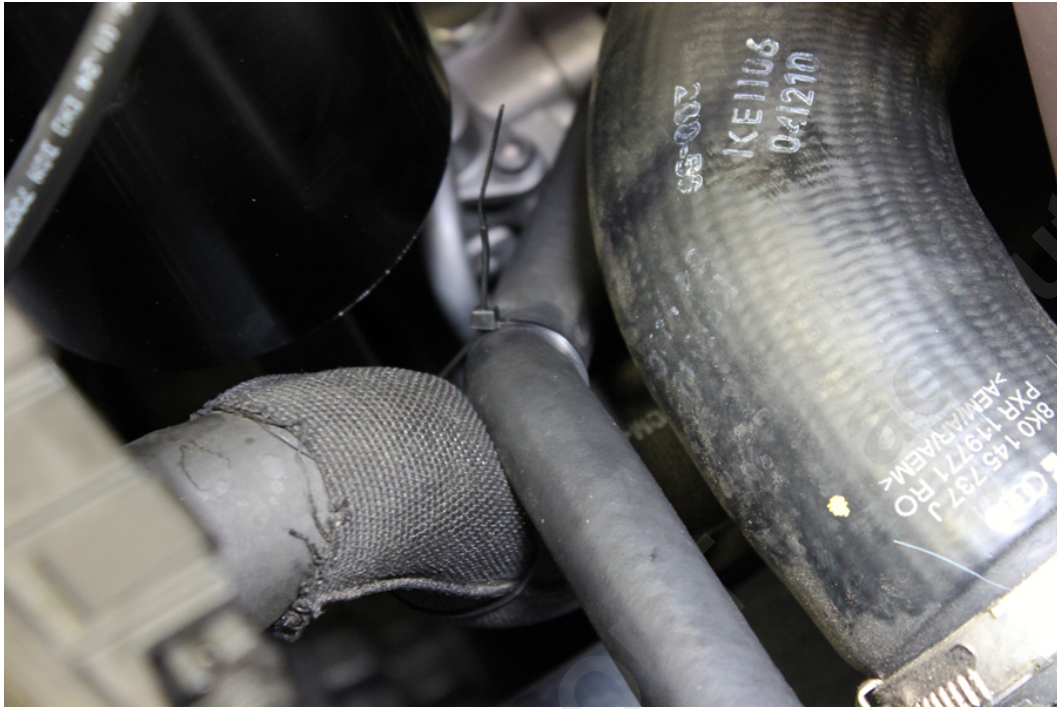

Step 11 – Route the -10 AN Breather Hoses as pictured below, and secure to the Valve Cover Breather Adapter and Catch Can. Install the hose separator over the hoses and secure using the Allen bolt as pictured.



Step 12 – Reinstall your engine cover by using your hands and/or opposable thumbs to push the plastic cover down onto the locating tabs. Give yourself a high-five!

Draining the Catch Can – The Catch Can can be drained by removing the top bracket, and accessing the 1/8" NPT Plug at the bottom of the can. The Catch Can can also be completely disassembled by unscrewing the top and bottom plates from the body. Be mindful of the o-ring seals when reassembling the can.

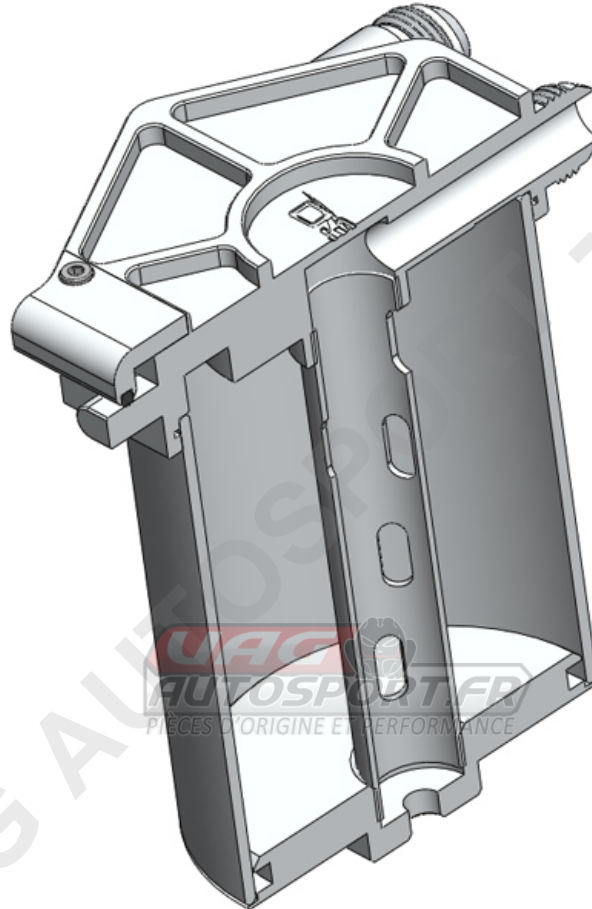

034MOTORSPORT